

## Fact sheet

# CAD Colour codes

| RGB colour no. |     |     | Tolerance in mm surface offset |                   | Surface     | VDWF* | Application examples / Comments   |
|----------------|-----|-----|--------------------------------|-------------------|-------------|-------|---|
| R              | G   | B   | pocket (interior)              | insert (exterior) |             |       |   |
| 0              | 0   | 255 | H7                             | g6                | Ra 0,8-1,6  | ●     | Applies to fitting bores, length / width of pockets and diameters                   |
| 0              | 255 | 255 | H5                             |                   | Ra 0,8-1,6  | ●     |   |
| 255            | 175 | 175 | ±0,005                         |                   | Ra 0,8-1,6  | ●     | ± Tolerances for individual surfaces (also applicable to diameter tolerances)       |
| 255            | 128 | 0   | ±0,01                          |                   | Ra 0,8-1,6  | ●     |   |
| 128            | 128 | 0   | ±0,02                          |                   | Ra 0,8-1,6  | ●     |   |
| 64             | 255 | 64  | ±0,05                          |                   | Ra 3,2      | ●     |   |
| 183            | 183 | 220 | ±0,1                           |                   | Ra 3,2      | ●     | Applies to basic bodies and all inaccurate holes and surfaces                       |
| 95             | 0   | 0   | ±0,5                           |                   | Ra 3,2-12,5 | ●     | ± Tolerances for individual surfaces (also applicable to diameter tolerances)       |
| 255            | 255 | 0   | DIN/ISO                        |                   |             | ●     | Metric standard threads (diameter of the core according to DIN / ISO)               |
| 255            | 175 | 0   | DIN/ISO                        |                   |             | ●     | Metric fine threads (diameter of the core according to DIN / ISO)                   |
| 211            | 45  | 96  | DIN/ISO                        |                   |             | ●     | Inch threads (diameter of the core according to DIN / ISO)                          |
| 255            | 95  | 0   |                                |                   |             | ●     | Special threads   |
| 252            | 228 | 214 |                                |                   |             | ●     | Surfaces that are freely defined via PMI, drawings etc.                             |
| 242            | 242 | 242 |                                |                   |             | ●     | Surfaces that are freely defined via PMI, drawings etc.                             |
| 226            | 239 | 218 |                                |                   |             | ●     | Surfaces that are freely defined via PMI, drawings etc.                             |
| 0              | 128 | 0   | 0+0.0075                       |                   | Ra 0,8-1,6  |       | 0+0.____Tolerances for individual surfaces (also applicable to diameter tolerances) |
| 255            | 128 | 128 | 0+0,01                         |                   | Ra 0,8-1,6  | ●     |   |
| 255            | 0   | 255 | 0+0,015                        |                   | Ra 0,8-1,6  |       |   |
| 0              | 64  | 128 | 0+0,02                         |                   | Ra 0,8-1,6  | ●     |   |
| 128            | 0   | 0   | 0+0,05                         |                   | Ra 1,6-3,2  | ●     |   |
| 255            | 192 | 255 | 0+0,1                          |                   | Ra. 3,2     | ●     |   |
| 255            | 192 | 100 | 0-0,01                         |                   | Ra 0,8-1,6  | ●     | 0-0.____Tolerances for individual surfaces (also applicable to diameter tolerances) |
| 255            | 255 | 192 | 0-0,015                        |                   | Ra 0,8-1,6  |       |   |
| 192            | 255 | 192 | 0-0,02                         |                   | Ra 0,8-1,6  | ●     |   |
| 198            | 89  | 17  | 0-0,04                         |                   | Ra 0,8-1,6  |       |   |
| 128            | 0   | 255 | 0-0,05                         |                   | Ra 1,6-3,2  | ●     |   |
| 0              | 164 | 164 |                                |                   |             |       |   |

### Manufacturing standards:

To enable a clear distinction, the threads must be designed with core diameters according to DIN / ISO. The surfaces on the basic body for which no attributes have been specified will be machined to the tolerance DIN ISO 2768mH. The Meusburger standard complies with the tolerances specified in the relevant Meusburger product information and machining standards.

Tolerance corresponds to the VDWF colour codes

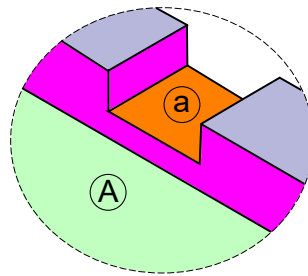
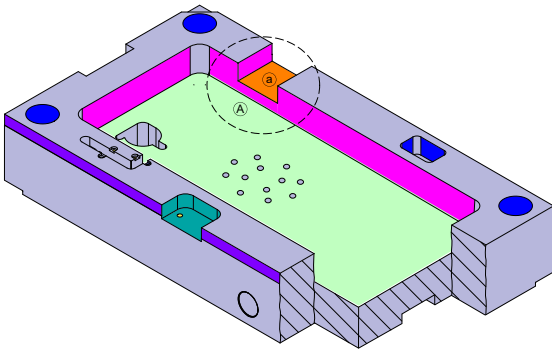
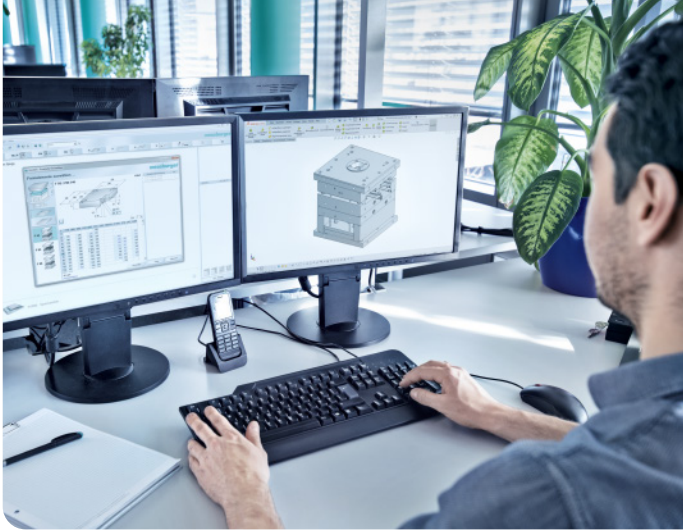

For interrelated surfaces, the reference surfaces are marked with capital letters and the corresponding depths with lower case letters.

If a surface has a plus tolerance field, the nominal dimension of the pocket, bore or bottom area will be larger.

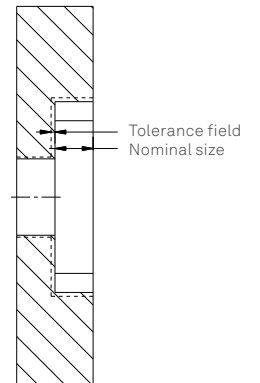
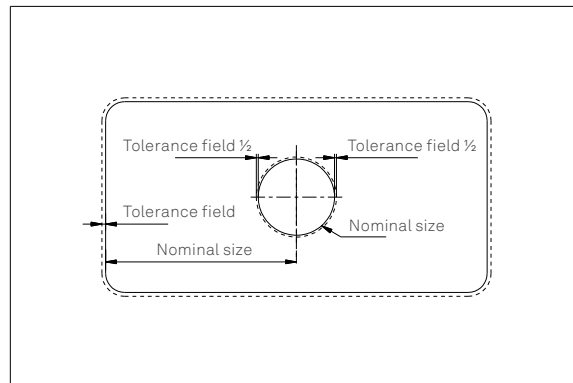

If a surface has a minus tolerance field, the nominal dimension of the pocket, bore or bottom area will be smaller.

